



## Millway

**£1,250,000**

Cosway Estates are delighted to offer for sale this handsome double fronted detached family home set on a wide plot at the top of this ever popular road. Arranged over Three floors and boasting from a total square footage of 3810' the house is currently arranged as Five Bedrooms, Two Bathrooms (1 en-suite), Kitchen, Four Reception Rooms, Utility Room & Guest Wc. Externally there is a landscaped west facing 100' rear Garden, off street parking for several cars via carriage driveway and garage. Millway is well located for the shops, transport facilities and places of worship. Sole Agents.

### Viewing

Please contact our London Office on 020 8959 0011 if you wish to arrange a viewing appointment for this property or require further information.



5



2



3



# Floor Plan

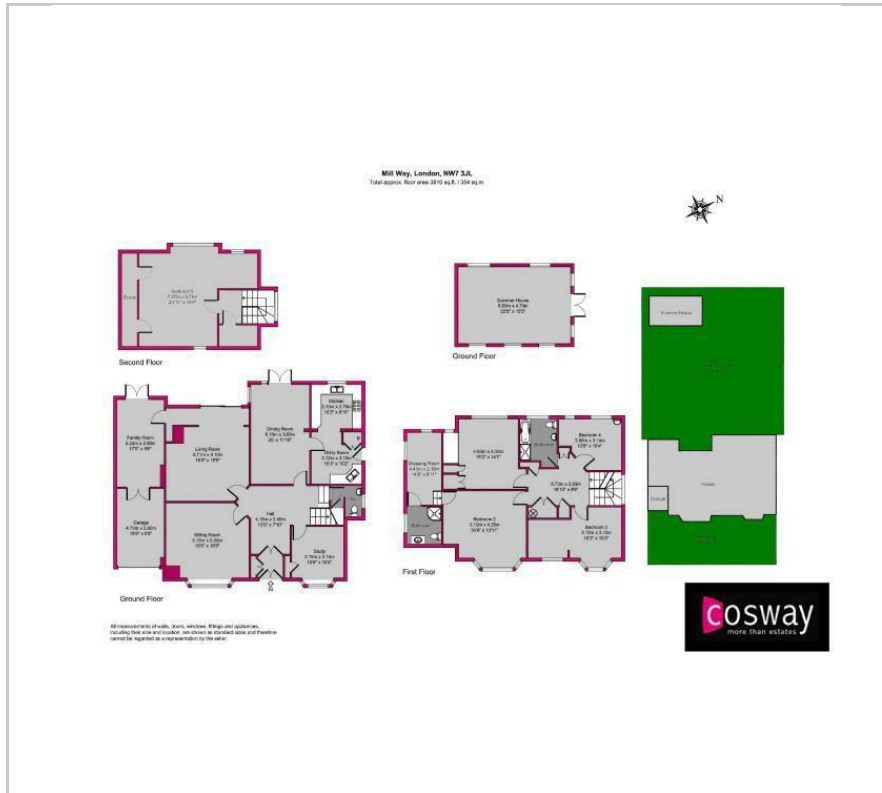

# Area Map

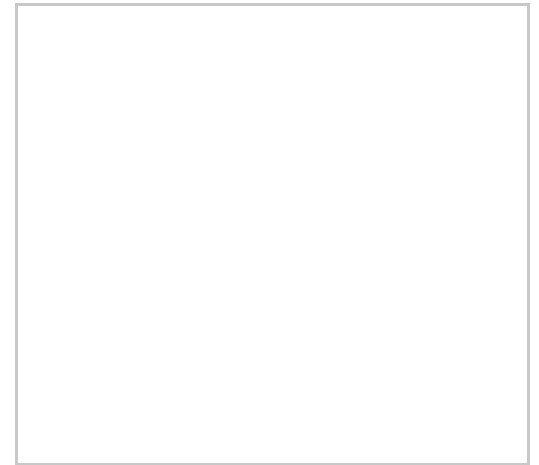

# Energy Efficiency Graph

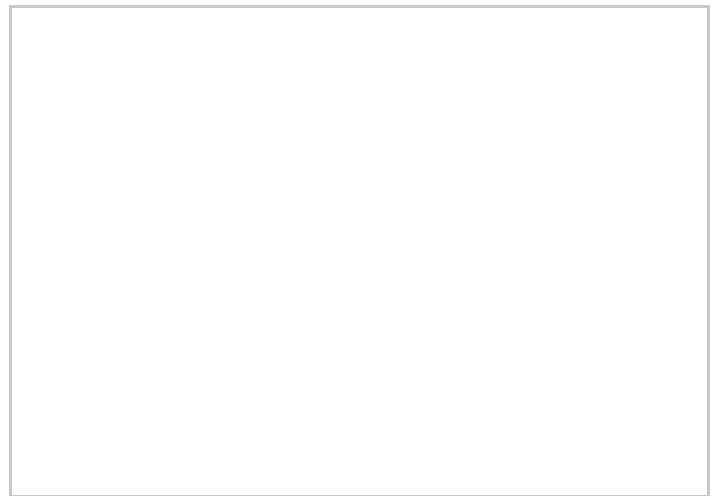
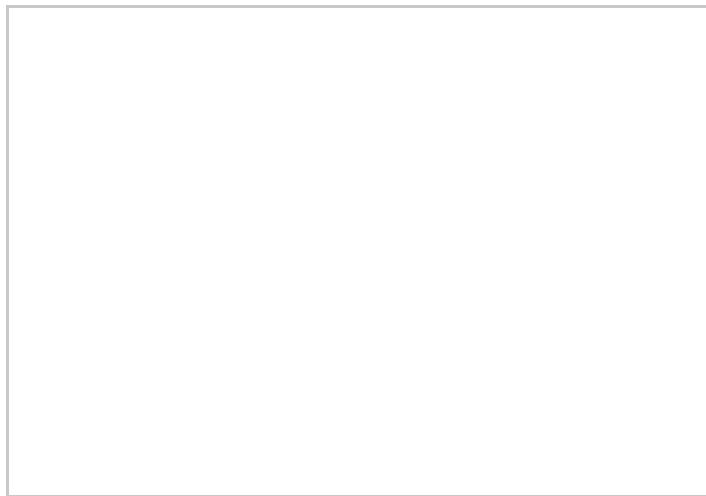
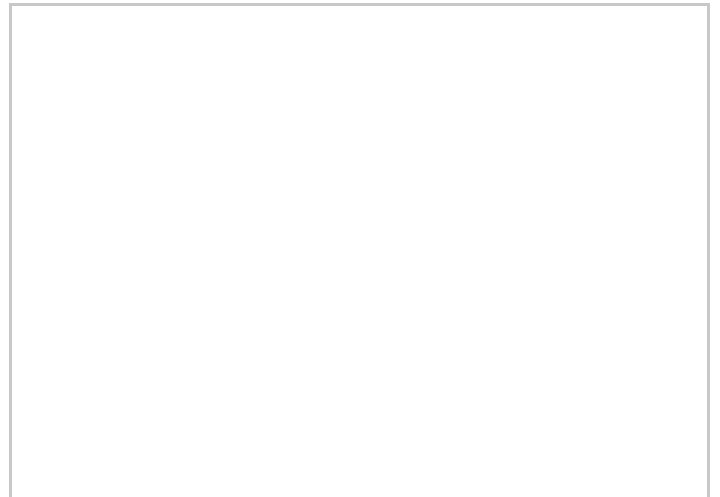
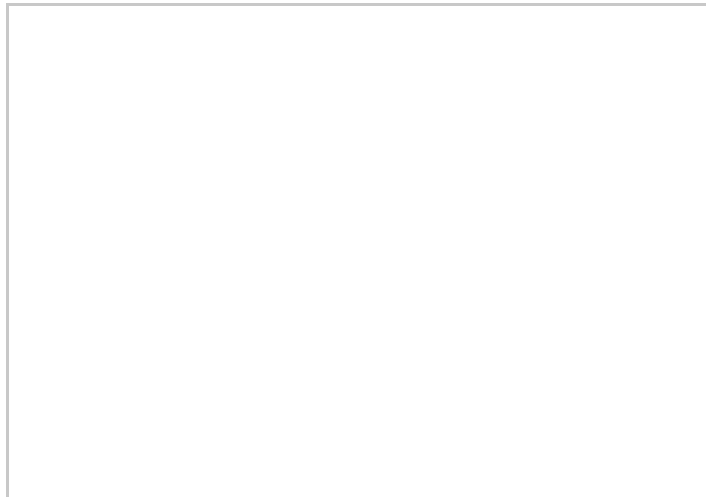
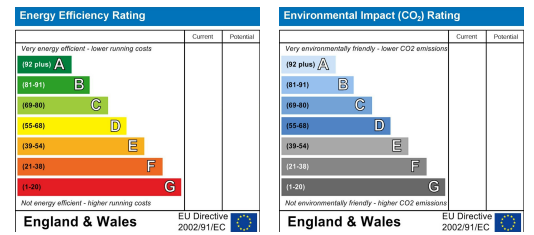

These particulars, whilst believed to be accurate are set out as a general outline only for guidance and do not constitute any part of an offer or contract. Intending purchasers should not rely on them as statements of representation of fact, but must satisfy themselves by inspection or otherwise as to their accuracy. No person in this firm's employment has the authority to make or give any representation or warranty in respect of the property.